

Aldreds
Estate Agents



9 Mulberry Grove

Bradwell, Great Yarmouth, NR31 8QJ

Guide Price £250,000 - £260,000



3



1



1



D

9 Mulberry Grove

Bradwell, Great Yarmouth, NR31 8QJ

**** GUIDE PRICE £250,000 - £260,000**** This 3 bedroom link-detached bungalow is pleasantly positioned in a cul-de-sac and offered for sale with no onward chain. The property has gas central heating and UPVC double glazing. There is an adjoining single garage and an east/south-east facing rear garden.

Entrance Hall

UPVC entrance door with double glazed panel and UPVC double glazed side windows. Two built-in storage cupboards. Built-in airing cupboard with slatted shelves and hot water cylinder. Loft access hatch.

Lounge

14'11" x 11'11" (4.55m x 3.63m)

Radiator. Television and telephone points. UPVC double glazed window to front aspect.

Kitchen

11'11" x 7'11" (3.63m x 2.41m)

Worktops with cupboards and drawers below and an inset stainless steel single drainer sink. Tiled splashback. Matching wall cupboards. Space for electric cooker. Space for fridge/freezer. Breakfast bar. Radiator. Wall mounted gas fired boiler. UPVC double glazed window to rear aspect. UPVC double glazed door to utility room.

Utility Room

5'5" x 4'1" (1.65m x 1.24m)

Plumbing for washing machine. UPVC double glazed windows to side and rear. UPVC door with double glazed panel to the rear garden.

Bedroom 1

16'3" x 10'9" (4.95m x 3.28m)

Radiator. Step up to a tiled shower cubicle with an electric shower unit and folding shower screen. UPVC double glazed window to rear aspect.

Bedroom 2

12'1" x 7'11" plus door recess (3.68m x 2.41m plus door recess)

Radiator. UPVC double glazed window to front aspect.

Bedroom 3

8'8" x 7'10" (2.64m x 2.39m)

Radiator. UPVC double glazed window to front aspect.

Bathroom

7'10" x 5'8" plus door recess (2.39m x 1.73m plus door recess)

White suite comprising panelled bath, WC and wash basin with cupboard below. Three quarter tiled walls. Radiator. UPVC double glazed window to rear.





Outside

18'11" x 8'3" (5.77m x 2.51m)

The front garden has been paved and shingled for low maintenance. A driveway leads to an adjoining single garage with up-and-over door. Part glazed door to rear. A wrought iron gate and pathway to the side of the property leads to the rear garden which is east/south-east facing and laid to lawn with shingled area and a paved patio. Timber built shed. Three concrete coal bunkers.

Tenure

Freehold.

Services

Mains water, gas, electricity and drainage are connected.

Council Tax

Great Yarmouth Borough Council - Band C

Location

Bradwell is a popular residential area adjoining Gorleston 2 miles from Great Yarmouth Town centre * There are a variety of local shops * Schools * Medical centre * Regular bus services to the main shopping areas * Indoor swimming pool and recreation areas.

Directions

Leave Gorleston on the A143 Beccles Road from the A47 and follow the road to Bradwell. Proceed over the traffic lights and take the first turning on the right onto Sun Lane. At the end of Sun Lane follow the road round to the left and take the first turning on the left into Mulberry Grove.

what3words

///lifestyle.ember.buggy

Ref: G18497/04/26



Floor Plan

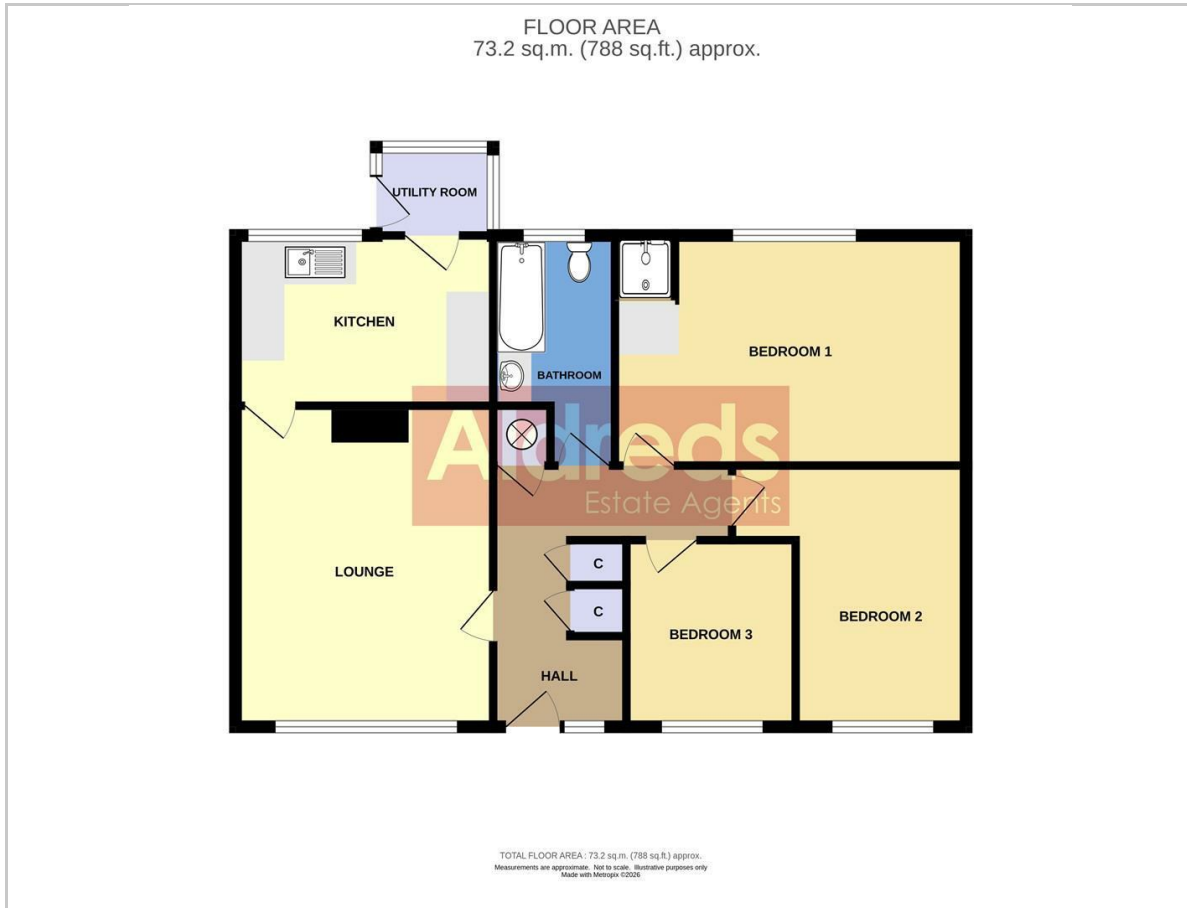

Viewing

Please contact our Aldreds Gorleston Office on 01493 664600 if you wish to arrange a viewing appointment for this property or require further information.

Disclaimer

These particulars are issued on an understanding that all negotiations shall be conducted through Messrs. Aldreds. Please note: Messrs. Aldreds for themselves and for the vendors or lessors of this property whose agents they are given notice that: 1. Particulars are set out as a general outline only for guidance of intending purchasers or lessees, and do not constitute nor constitute part of, an offer or contract. 2. All descriptions, dimensions, references to condition and necessary permissions for use and occupation, and other details are given without responsibility and any intending purchasers or tenants should not rely on them as statements or representations of fact but must satisfy themselves by inspection or otherwise as to the correctness of each of them. 3. No person in the employment of Messrs. Aldreds has any authority to make or give any representation or warranty whatever in relation to this property. 4. If you are proposing to visit the property and are travelling some distance please check with Aldreds on the issue of availability prior to travelling. 5. Aldreds Property Consultants and associated services may offer additional services to the prospective purchaser for which they will be entitled to receive a commission.

Aldreds are pleased to be working with Mortgage Advice Bureau. They're an award-winning mortgage broker with over 1,400 advisers across the UK, and have access to over 12,000 mortgage products from over 90 lenders. Aldreds Estate Agents Ltd receive a commission of £200 on each completed case. Your home may be repossessed if you do not keep up repayments on your mortgage. There may be a fee for mortgage advice. The actual amount you pay will depend upon your circumstances. The fee is up to 1%, but a typical fee is 0.3% of the amount borrowed. Mortgage Advice Bureau is a trading name of Mortgage Seeker Limited which is an appointed representative of Mortgage Advice Bureau Limited and Mortgage Advice Bureau (Derby) Limited which are authorised and regulated by the Financial Conduct Authority. Mortgage Seeker Limited Registered Office: Lovewell Blake, Sixty Six North Quay, Great Yarmouth, Norfolk, NR30 1HE. Registered in England Number: 03721415. 6. Potential purchasers should check with their providers that the broadband and mobile phone coverage they would require is available.

Area Map

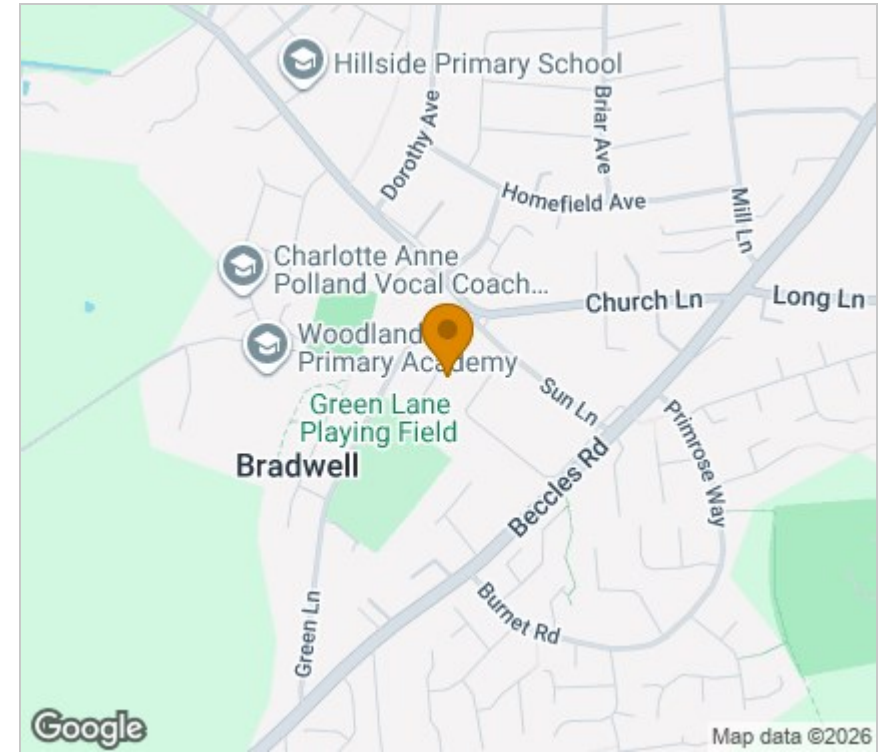

Energy Efficiency Graph

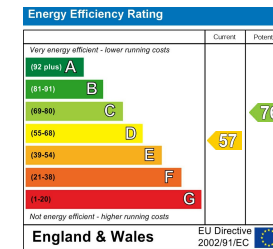

149 High Street, Gorleston, Norfolk, NR31 6RB

Tel: 01493 664600 Email: gorleston@aldreds.co.uk <https://www.aldreds.co.uk/>

Registered in England Reg. No. 08945751 Registered Office: 17 Hall Quay, Great Yarmouth, Norfolk NR30 1HJ

Directors: Mark Duffield B.S.c. FRICS. Dan Crawley MNAEA Paul Lambert MNAEA